

ENGINEERING RESPONSIBILITY SEPIA

HS-FIXTURE-BRACKET

00										
----	--	--	--	--	--	--	--	--	--	--

SYM	REVISIONS	APPROVED	DATE
1	AS ISSUED		01/03/27

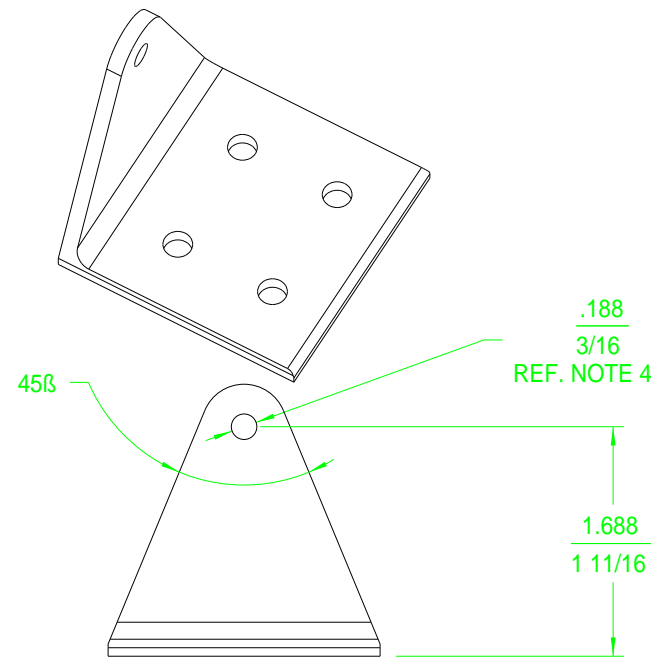
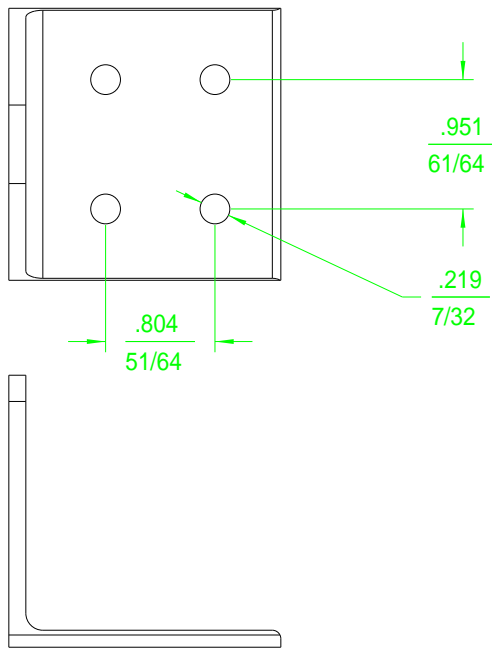

5. FIVE BRACKETS REQUIRED FOR RV-6 HS FIXTURE.

4. PIVOT HOLE SHOWN IS FINAL SIZE. FABRICATE WITH SMALLER PIVOT HOLE (1/32" - 1/16") THEN DRILL TO SIZE SHOWN AFTER ALIGNING ALL BRACKETS ON FIXTURE.

3. HEIGHT TO PIVOT HOLE SUGGESTED ONLY.

2. MOUNTING HOLE GEOMETRY SUGGESTED ONLY.

1. MATERIAL AVAILABLE FROM HOME DEPOT AND MANY OTHER COMMON SOURCES.

NOTES: (UNLESS OTHERWISE SPECIFIED)

DO NOT SCALE THIS DRAWING

<p>UNLESS OTHERWISE SPECIFIED</p> <ul style="list-style-type: none"> DIMENSIONS ARE IN INCHES THIRD ANGLE PROJECTION TOLERANCES <p>STRIKE OUT OR FILL IN AS NEEDED</p>	1	~1'	ALU. ANGLE 2 X 2 X 1/8				
	ITEM	QTY.	PART/MATERIAL-DESCRIPTION	MATL-PART NO.	MATL-DWG NO.	MATL-SPEC.	
	TEDD MCHENRY		01/03/27	RV-6 HORI. STAB. FIXTURE BRACK.	Van's Air Force Western Canada Wing		
	DRAWN BY		DATE				
ENGINEER/CHECKER			TITLE	00000-00000			
RELEASE TO PROD.				PART NUMBER			
FILE REVISED BY			FULL SCALE	1 SHEET	1 OF	HS-FIXTURE-BRACKET	

302417 SD ANNOTATOR